

LED BUS LIGHTING

TLM SERIES - PREMIUM SAVER T12 SIZE



NOTES & PATENT INFORMATION

US Patent #7,307,391 8,115,411 8,791,650
 9,179,513
 Canada Patent #2,651,224 2,555,065 2,831,641
 International Patents Pending
 For complete and up to date patent information see
 our website

OPTIONAL FEATURES

- lengths of 24", 36", 48"
- Colors: Warm White, Blue, other colors upon request
- Operational voltages for special applications
- Bi-Pin types

DESCRIPTION

The LED Lighting tube has been designed to work with conventional fluorescent fixtures. To replace the short lived fluorescent lamps that are typically used in Interior Transportation lighting. The LED Lighting tube can be used to retrofit existing fluorescent installations, or for new install.

These products are superior in appearance allowing the use of LEDs but creating the appearance of fluorescent. The Premium lighting systems offers customers the best in new technology.

The Premium lamps are designed to have an equal appearance and higher performance in any transportation application when compared to fluorescent lamps.

FEATURES

- Solid state lighting device, works well in harsh environments of hot or cold temperatures
- Instant on, no warm up time
- Lasts at least 10 times longer than fluorescent
- NO EMI emissions, to eliminate radio interference
- Design to replace conventional fluorescent lamps
- Lead Free Compliant, Mercury Free
- Vibration proof features

STANDARD FEATURES

- 60" and 72" lengths
- Cool White LEDs
- 24V Operating Voltage
- Double Frosted lens
- Single Pin, Instant start connection type

DIMENSIONS

T12 Diameter (Side View)

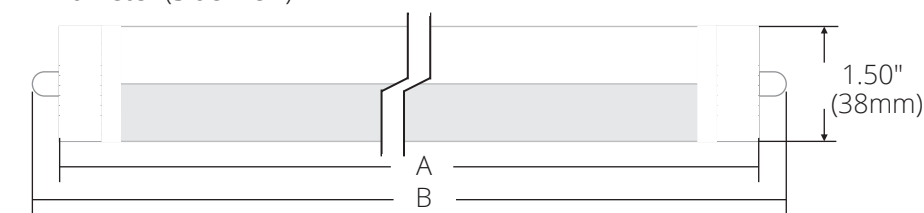

FA8

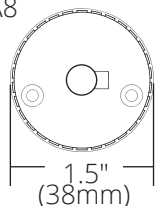

RDCB (r17d)

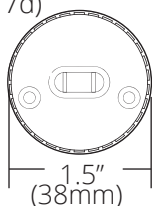

Standard Length	A		B	
	Inch	cm	Inch	cm
24	21.18	538.0	21.825	554.4
36	33.18	842.8	33.825	859.2
48	45.18	1147.6	45.825	1164.0
60	57.18	1452.4	57.825	1468.8
72	69.18	1757.2	69.825	1773.6

Finished Weight	
T12	
g	lbs
380	0.84
540	1.19
732	1.61
923	2.03
1115	2.46

ELECTRICAL STATS & OPERATING FUNCTIONS

Type	Nominal Length (inch)	Input Voltage (DC Volts)	Lens Type	High Intensity (100% Brightness)			Low Intensity (20% Brightness)		
		Input Current (DC Amps)		Intensity (Estimated Lumens)	Power Consumption (Watts)	Input Current (DC Amps)	Intensity (Estimated Lumens)	Power Consumption (Watts)	
		TYP		TYP	TYP	TYP	TYP	TYP	
COOL WHITE									
TLM	24	24	Double Frosted	0.46	510	11	0.09	102	2.2
	36			0.71	742	17	0.14	148	3.4
	48			0.94	1021	23	0.19	204	4.5
	60			1.18	1299	28	0.24	260	5.7
	72			1.42	1578	34	0.28	316	6.8

ORDERING INFORMATION

SERIES	DIAMETER	PIN TYPE	LENGTH	VOLTAGE	COLOR	LENS TYPE	FUNCTION
TLM	T12	X	XX	24	X	X	X
		F = FA8	24*	24V	C = Cool White (5700K)	D = Double Side	S = Single Intensity
		R = RDCB (R17D)	36*		A = Amber*	Frosted, white	D = Dual Intensity
		G = G13	48*		R = Red*	S = Single side	(100% - 20%)
			60		G = Green*	frosted, White*	E = Extinguishable
			72		B = Blue	B = Blue Lens	(100% - 0%)
						(only with white LEDs)	

Example:

TLM-T12-FA8-72-24-C-D-D = LED Transit Light, Premium Saver, T12 Size, FA8 - Single Pin, 72" Long, 24V, Cool White, Double Frosted Lens, Dual Intensity

* Custom order item, contact LED Smart Inc. for more details.